

24' X 48' PRODUCTION OPERATIONS FACILITY



Production Ready

The 24' x 48' Production Operations Facility provides Class 1, Division 1 extraction rooms and flexible space for post processing.

XTREME CUBES[™]
BY XTREME CUBES CORPORATION 

24' X 48' PRODUCTION OPERATIONS FACILITY

Contact Us
T: 800-497-1704
E: cuberfq@xmf.com

STANDARD FEATURES

- 12'w x 24'l x 10'h space frame with built-in fork pockets
- Imron polyurethane & epoxy paint, polyurea coating
- 6' x 7' steel double door
- 3' x 7' steel man doors (4)
- 3' x 7' freezer door
- Exterior single-phase load center and breakers (4)
- 8' interior LED lights (8)
- 4' interior explosion-proof LED lights (4)
- Emergency ballasts (3)
- Exterior light
- Light switches (3)
- Exit light
- Duplex outlets (18)
- Explosion-proof light switches (4)
- Explosion-proof simplex receptacles (3)
- Seal offs (3)
- 3-megapixel camera
- 12-megapixel panoramic camera
- Access control provisions
- 5-ton wall-mount heat pump (3)
- Condenser shelves (3)
- Electric tankless water heater
- Mop sink with faucet
- Refrigeration package
- Stainless steel hand sink with eyewash
- Stand-alone three compartment sink
- Vacuum oven shelves (2)
- 24" x 72" chrome wire shelves (2)
- Utilite wall & ceiling paneling
- 3/16" non-slip coated steel plate flooring
- R-21 spray foam insulation in walls
- R-28 spray foam insulation in floor
- R-35 spray foam insulation in roof
- R-42 spray foam insulation in walls, floor, and roof of freezer
- All plumbing parts and labor
- Two layers of finished 5/8" drywall in extraction area
- Roof-mount exhaust fan, ductwork installation

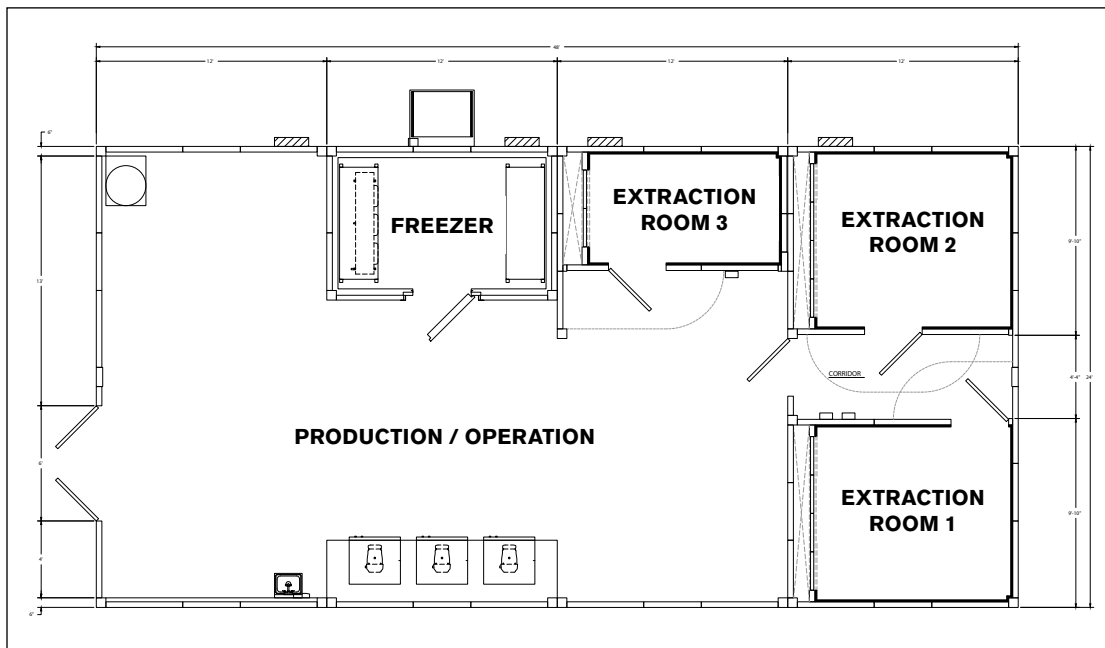

ABOUT XTREME CUBES

- Welded structural steel tube frame enhances the Cube's overall strength and increases options for customization.
- The Production Cube height is 12'. Cube lengths and widths are available in increments of 8', 10' and 12'.
- Modular wall panels can be easily customized with doors, windows, and other options.
- Premium components are utilized inside and out for durability and long life.
- Each Cube is engineered to your specific location conditions to withstand snow load, wind load and seismic events.
- Utility connections are preconfigured for a convenient and simple installation.
- Installation is quick and simple. When delivered, Cubes can be set in position, connected to site utilities and ready to use immediately.

XTREME CUBES™

www.xtremecubescorp.com